

KENTUCKY EXTENSION  
HOMEMAKER ASSOCIATION



*Mapping  
Our future*

**84th Annual Meeting  
May 1-4, 2017  
Owensboro Convention Center  
Owensboro, Kentucky**

WELCOME TO  
OWENSBORO



**Monday, May 1**

- 8:30 a.m.—12:30 p.m. Tour 1: Bill Monroe's Home Place, Rosine Cemetery and Rosine Barn  
..... Lower Lobby
- 12:00 p.m.—6:00 p.m. Early Registration ..... East Lower Lobby  
Quilt Square Check-In ..... East Lower Lobby
- 12:30 p.m.—5:00 p.m. FCS Agent In-Service ..... East Ballroom C-E
- 1:00 p.m.—4:00 p.m. Tour 2: Daviess County Barn Quilt Trail and Agritourism Tour  
..... Lower Lobby
- 3:00 p.m.—4:30 p.m. Hands-on Creative Classes: Session 1  
Patriotic Wreath ..... Riverview Room  
Personalized Pendant Necklace and Birds Nest Necklace. .... Riverview Room  
Kentucky Door Hanger. .... Riverview Room  
Mason Lid Ornament and Recycled Storage Jar. .... Riverview Room  
Snow Globe Candle Holder ..... Meeting Room 230  
Beaded Wire Angel ..... Meeting Room 231
- 4:45 p.m.—5:15 p.m. KEHA: Women Walk the World (Riverfront Walk) .... West Lower Lobby
- 6:00 p.m.—7:30 p.m. Hands-on Creative Classes: Session 2  
Patriotic Wreath ..... Riverview Room  
Personalized Pendant Necklace and Birds Nest Necklace. .... Riverview Room  
Kentucky Door Hanger. .... Riverview Room  
Mason Lid Ornament and Recycled Storage Jar. .... Riverview Room  
Snow Globe Candle Holder ..... Meeting Room 230  
Beaded Wire Angel ..... Meeting Room 231

**Tuesday, May 2**

- 8:00 a.m.—4:00 p.m. Registration ..... East Lower Lobby  
Voting Delegate Sign-In ..... East Lower Lobby
- 8:00 a.m.—10:00 a.m. Silent Auction & Raffle Check-In ..... Lower Level—Exhibit Hall 1  
Homemaker Showcase Set-Up ..... Lower Level—Exhibit Hall 1
- 8:00 a.m.—12:00 p.m. Quilt Square Check-In ..... East Lower Lobby
- 8:15 a.m.—4:30 p.m. FCS Agent Training ..... East Ballroom C-E
- 9:30 a.m.—12:00 p.m. Cultural Arts Check-In ..... Lower Level—Exhibit Hall 2
- 9:30 a.m.—Lincoln Trail, Mammoth Cave and Pennyriple Areas  
10:00 a.m.—Louisville, Bluegrass and Lake Cumberland Areas  
10:30 a.m.—Fort Harrod, Green River, Purchase and Northeast Areas  
11:00 a.m.—Quicksand, Wilderness Trail, Northern Kentucky and Licking River Areas  
11:30 a.m.—All late arrivals

*Please silence all cell phones and electronic devices during sessions.*

## Tuesday, May 2

10:00 a.m.—11:15 a.m. SEMINARS—Session 1

- Food Fads: The Gluten Free Diet and Celiac Disease** . . . . . East Ballroom A  
Emily Smith, Methodist Hospital Prevention and Wellness Services
- The Buzz About Honey** . . . . . East Ballroom B  
Cecelia Hostilo, Trigg County Extension Agent for Family and Consumer Sciences  
Education and Melissa Goodman, Carlisle/Hickman County Extension Agent for  
Family and Consumer Sciences Education
- KEHA Basics** . . . . . West Ballroom A  
Kim Henken, KEHA State Advisor
- How a Children’s Book Happens**. . . . . West Ballroom B  
Eddie Price, Author
- Lessons Learned**. . . . . Meeting Room 230 (2nd Level)  
Warren Beeler, Executive Director, Governor’s Office of Agricultural Policy
- Silk Ribbon Embroidery**. . . . . Meeting Room 231 (2nd Level)  
Mary Hixson, Garrard County Extension Agent for Family and Consumer  
Sciences Education
- Sales Tax: What Do You Need to Know?**. . . . . East Ballroom D  
Richard Dobson, Executive Director of Sales and Use Tax; Ricky Haven, Director of Sales  
and Use Tax Division; and Jeremy Simpson, Manager of Sales and Use Tax  
Compliance Branch

- 10:00 a.m.—5:00 p.m. Trade Show Open . . . . . Lower Level—Exhibit Hall 1  
KEHA Merchandise Store . . . . . Lower Level—Exhibit Hall 1  
Silent Auction & Raffle Open . . . . . Lower Level—Exhibit Hall 1  
Homemaker Showcase Open . . . . . Lower Level—Exhibit Hall 1

### ***LUNCH ON YOUR OWN (Café open in West Lower Lobby)***

1:00 p.m.—2:30 p.m. OFFICER TRAINING

- President/President Elect . . . . . East Ballroom B  
1st & 2nd Vice President . . . . . East Ballroom A  
Secretary . . . . . West Ballroom A  
Treasurer . . . . . West Ballroom B

2:00 p.m.—5:00 p.m. Quilt Square Viewing and Bidding . . . . . East Lower Lobby

3:15 p.m.—4:30 p.m. SEMINARS—Session 2

- Purchase Proud** . . . . . East Ballroom A  
Purchase Area Master Food Volunteers—Julie Hook, Riff Turner, Carol Coplen and  
Lois Stephany
- Pinterest Party: Beyond Crafts and Apps** . . . . . East Ballroom B  
Jennifer Hunter, Associate Extension Professor for Family Financial Management and  
Mindy McCulley, Extension Specialist for Instructional Support
- Successful Pie Baking**. . . . . West Ballroom A  
Leslie Workman, Pike County Extension Agent for Family and Consumer  
Sciences Education
- Homemaking on the Kentucky Frontier: 1811-1815**. . . . . West Ballroom B  
Eddie Price, Author
- Engage**. . . . . Meeting Room 230 (2nd Level)  
Warren Beeler, Executive Director, Governor’s Office of Agricultural Policy

*Please silence all cell phones and electronic devices during sessions.*

**Tuesday, May 2**

3:15 p.m.—4:30 p.m. SEMINARS—Session 2 (continued)

**Silk Ribbon Embroidery.** (continued from morning session) . . Meeting Room 231 (2nd Level)  
Mary Hixson, Garrard County Extension Agent for Family and Consumer  
Sciences Education

**Kentucky ACWW Tea** . . . . . Riverview Room  
Kentucky ACWW Network

6:00 p.m. OPENING BANQUET . . . . . West Ballroom C-E  
Marlene McComas, KEHA 1st Vice President, Presiding  
Inspirational Thought—Joyce Crigler, Louisville Area President

**DINNER**

Greetings and Welcome to the 2017 KEHA State Meeting —  
Edna McCrady, Green River Area President

Welcome to Owensboro  
Al Mattingly, Daviess County Judge Executive

Introduction of Guests—Marlene McComas

Greetings from University of Kentucky  
Dr. Gary Palmer, Interim Associate Dean  
Cooperative Extension Service, University of Kentucky,  
College of Agriculture, Food and Environment  
Dr. Ann Vail, Director, School of Human Environmental Sciences and  
Assistant Director, Family and Consumer Sciences Extension

**Ovarian Cancer Fund Presentations—**

Michelle Lawson, KEHA Chairman for Food, Nutrition, & Health  
Letcher County - largest amount per member (\$28.37 per member)  
Barren County - largest amount overall (\$4,165)  
Additional recognitions listed on page 5.

Presentation to  
John R. van Nagell, Jr., M.D., Professor and  
Edward J. Pavlik, Ph.D., Associate Professor,  
Division of Gynecologic Oncology, University of Kentucky Markey Cancer Center

Introduction of Speaker—Marlene McComas, KEHA 1st Vice President

**Tim and Nicki Farmer, *Tim Farmer’s Country Kitchen***

Closing Remarks—Marlene McComas

*Please silence all cell phones and electronic devices during sessions.*

## OVARIAN CANCER AWARDS

### Counties with largest donations per member:

1st Place—Letcher County      3rd Place—Barren County  
 2nd Place—Muhlenberg County

### Counties with largest overall donations:

1st Place—Barren County      3rd Place—Muhlenberg County  
 2nd Place—Mason County

### Counties contributing over \$1,000:

Barren      Butler      Letcher      Logan      Mason      Muhlenberg

### Counties with 100% donations to Ovarian Cancer Research:

(\*Denotes counties with over 100% donations.)

<u><i>Bluegrass</i></u>	<u><i>Lake Cumberland</i></u>	<u><i>Louisville</i></u>	<u><i>Northern Ky</i></u>	<u><i>Quicksand</i></u>
Bourbon	Adair	Bullitt	*Boone	Breathitt
*Clark	Casey	*Henry	*Campbell	Knott
*Estill	Clinton	*Jefferson	Carroll	Leslie
*Fayette	Cumberland	*Shelby	Gallatin	*Letcher
*Harrison	Green	Oldham	Grant	Owsley
*Madison	McCreary	Spencer	Kenton	Perry
Nicholas	*Pulaski	Trimble	Pendleton	*Wolfe
Powell	Russell			
	Taylor			
	*Wayne			
<u><i>Fort Harrod</i></u>	<u><i>Licking River</i></u>	<u><i>Mammoth Cave</i></u>	<u><i>Pennyrile</i></u>	<u><i>Wilderness Trail</i></u>
Anderson	Bath	*Allen	*Caldwell	Bell
*Boyle	Bracken	*Barren	Christian	*Clay
Franklin	Fleming	*Butler	Crittenden	Harlan
Garrard	Lewis	*Edmonson	Hopkins	Jackson
*Jessamine	*Mason	Hart	*Lyon	Knox
Lincoln	Menifee	*Logan	*Muhlenberg	*Laurel
Mercer	Montgomery	Monroe	Todd	Rockcastle
Woodford	Morgan	*Simpson	Trigg	Whitley
	Rowan	*Warren		
<u><i>Green River</i></u>	<u><i>Lincoln Trail</i></u>	<u><i>Northeast</i></u>	<u><i>Purchase</i></u>	
Hancock	*Breckinridge	Carter	Ballard	
Henderson	Grayson	*Floyd	Calloway	
McLean	*Hardin	*Greenup	Carlisle	
Ohio	LaRue	Johnson	Fulton	
Union	Marion	*Lawrence	*Graves	
Webster	*Meade	Magoffin	Hickman	
	*Nelson	*Pike	*Marshall	
	Washington		McCracken	

County with largest number of first time ovarian cancer screening participants: Hickman

### Ovarian Cancer Fundraising Contest:

1st Place—Butler County  
 2nd Place—Lincoln County

*Please silence all cell phones and electronic devices during sessions.*

**Wednesday, May 3**

- 8:15 a.m.—4:30 p.m. FCS Agent Training . . . . . East Ballrooms C-E
- 8:00 a.m.—9:45 a.m. Registration. . . . . East Lower Lobby
- 8:00 a.m.—9:30 a.m. Voting Delegate Sign-In. . . . . East Lower Lobby
- 8:00 a.m.—2:00 p.m. Quilt Square Viewing & Bidding . . . . . East Lower Lobby
- 8:00 a.m.—3:00 p.m. Cultural Arts Viewing . . . . . Lower Level—Exhibit Hall 2
- 8:00 a.m.—3:00 p.m. Silent Auction Bidding. . . . . Lower Level—Exhibit Hall 2
- Homemaker Showcase . . . . . Lower Level—Exhibit Hall 2
- KEHA Merchandise Store. . . . . Lower Level—Exhibit Hall 2
- Trade Show Open . . . . . Lower Level—Exhibit Hall 2
- 8:00 a.m.—9:15 a.m. SEMINARS III
- Beekeeping** . . . . . Meeting Room 230 (2nd Level)
- Obbie Todd, Naturalist and Beekeeper
- Creating and Maintaining Family Traditions** . . . . . East Ballroom B
- Sally Mineer, Extension Specialist for Professional Development
- Wildflowers and Honey Bees** . . . . . West Ballroom B
- Steve Hahus, Biologist
- Yard and Garden Photography** . . . . . West Ballroom A
- Bonnie Nance, Daviess County Master Gardener and retired Professional Photographer
- Pennyrile Area Leaders Learn to “Lead with Love”** . . . . . East Ballroom A
- Angie York, Lyon County Extension Agent for Family and Consumer Sciences Education
- KEHA Choir Rehearsal.** . . . . . Lower Level—Exhibit Hall 3
- Wendy Hood, KEHA Choir Director
- 10:00 a.m.—11:30 a.m. Business Meeting . . . . . Lower Level—Exhibit Hall 3  
(reserved seating for voting delegates)
- 11:30 a.m.—4:00 p.m. Registration. . . . . East Lower Lobby
- 11:45 a.m.—1:45 p.m. Master Farm Homemakers Guild Luncheon. . . . . Riverview Room
- OR LUNCH ON YOUR OWN (Café Open West Lower Lobby)***
- 1:00 p.m.—2:30 p.m. Cultural Arts and Heritage Chairman Workshop . . . . . East Ballroom B
- 2:00 p.m.—3:30 p.m. EDUCATIONAL CHAIRMEN WORKSHOPS
- Environment, Housing and Energy. . . . . West Ballroom A
- 4-H Youth Development . . . . . Meeting Room 220 (2nd Level)
- Family and Individual Development . . . . . Meeting Room 230 (2nd Level)
- Food, Nutrition and Health. . . . . West Ballroom B
- International . . . . . Meeting Room 231 (2nd Level)
- Leadership Development . . . . . East Ballroom A
- Management and Safety . . . . . Meeting Room 210 (2nd Level)
- 2:00 p.m.—4:00 p.m. Master Farm Homemaker Guild Business Meeting. . . . . Riverview Room

*Please silence all cell phones and electronic devices during sessions.*

**Wednesday, May 3**

- 3:30 p.m.—5:00 p.m. Quilt Square Pick-Up and Pay. . . . .East Lower Lobby
- 4:00 p.m.—5:00 p.m. Silent Auction Pick-Up and Pay . . . . .Lower Level—Exhibit Hall 1  
Pick Up Showcase Displays. . . . .Lower Level—Exhibit Hall 1
- 4:00 p.m.—5:00 p.m. Cultural Arts Check-Out . . . . .Lower Level—Exhibit Hall 2

***DINNER ON YOUR OWN***

- 7:00 p.m. KEHA General Session. . . . . Lower Level—Exhibit Hall 3  
Sandra Lennon, KEHA Treasurer, Presiding  
Inspirational Thought—Julie Hook, Purchase Area President

Greetings

- Dr. Javiette Samuel, Interim Associate Director,  
School of Human Environmental Sciences
- Martha Boyd, President, Kentucky Master Farm Homemakers Guild
- Linda Kaletch, President, National Volunteer Outreach Network

KEHA Choir—Wendy Hood, Mercer County KEHA Member, Director  
*(See listing of choir members on page 17)*

Introduction of Speaker—Marlene McComas, KEHA 1st Vice President

**Colene Elridge, Owner and Chief Coach, Be More Consulting**

Cultural Arts Viewer’s Choice Winner—  
Presented by: Julia Lainhart, KEHA Cultural Arts Chairman

KEHA Development Grant and Mini-Grant Presentations—  
Marena Nelson, KEHA 2nd Vice President

Development Grants:

- Carlisle County: “Keep Your Balance”
- Casey County: “The Walnut Hills Project”
- Edmonson County: “Calming the Heart of Autism”
- Woodford County: “County Membership Drive”

Mini-Grants:

- Carlisle County: “You, Too, Can Yoga”
- Heather Norman-Burgdolf, Assistant Extension Professor:  
“Enhancing Diabetes Prevention thru FCS Extension”

Announcement of Theme Basket Winners—  
Dixie Utter, Pennyriple Area President

*Please silence all cell phones and electronic devices during sessions.*

**Thursday, May 3**

8:00 a.m. Awards Breakfast . . . . . West Ballroom C-E  
Marena Nelson, KEHA 2nd Vice President, Presiding  
Inspirational Thought—Debbie Pierce, Environment, Housing and  
Energy Chairman

Introduction of Guests—Marena Nelson

Greetings

Dr. Nancy Cox, Dean  
University of Kentucky, College of Agriculture, Food and Environment  
Dr. Cherry Kay Smith, Program Leader  
University of Kentucky, Family and Consumer Sciences Extension

***BREAKFAST***

AWARDS PRESENTATIONS—KEHA 2017 Awards & Contest Winners

**Membership—Marena Nelson, 2nd Vice President**

Largest % Increase  
1st Place—Breathitt County (67%)  
2nd Place—Carlisle County (34%)  
3rd Place—Bath County (31%)  
Largest Overall Increase  
1st Place—Fayette County (38)  
2nd Place—Bath County (37) and Gallatin (37)  
3rd Place—Carlisle County (36)

Increase of 25 or more members:  
Bath    Boyd    Bourbon    Carlisle  
Fayette    Gallatin    Shelby

50-Year, 60-Year and 65-Year Member Recognitions (see page 10)

**Cultural Arts & Heritage—Julia Lainhart, State Chairman**

**Poetry** 1st Place—Regena Lyons, Monroe County  
2nd Place—Daisy Lytle, Ohio County  
3rd Place—Theresa Oakes, Barren County

**Memoirs** 1st Place—Becky Greenwell, Union County  
2nd Place—Machele Bess, Owen County  
3rd Place—Joyce Wray, Barren County

**Short Stories**

1st Place—Joanne Fitzgibbon-Whitten, Meade County  
2nd Place—Theresa Oakes, Barren County  
3rd Place—Carol Chandler Russ, Oldham County

**Family and Individual Development—Marilyn Craycroft, State Chairman**

Strengthening Families  
1st Place—Crittenden County  
2nd Place—Hathaway Club, Boone County  
3rd Place—Ohio County

**4-H Youth Development—Nancy Snouse, State Chairman**

Promoting Local Businesses in Your Community  
1st Place—Mason County



**International**—Leonidisa Mundelius, State Chairman

Coins for Change Awards

1st Place—Meade County      2nd Place—Mason County  
3rd Place—Oldham County      Honorable Mention: Lincoln Trail Area

Kentucky Academy Fundraising Awards

1st Place—Madison County      2nd Place—Meade County  
3rd Place—Scott County      Honorable Mention: Bluegrass Area

Promoting International Month

1st Place—Monroe County      2nd Place—Ohio County  
3rd Place—Warren County

International Project Award

Sole Hope, Ballard County Extension Homemakers

Zero Hunger Challenge Award

McKinney Club, Lincoln County Extension Homemakers

Clothing and Textile Outreach for Ghana

1st Place—Ohio County      2nd Place—Davies County

Clean Water and Sanitation Project

1st Place—Hathaway Club, Boone County  
2nd Place—Graves County      3rd Place—Monroe County

Clean Water and Sanitation Contributions

County Awards:

1st Place—Monroe County      2nd Place—Grave County

Club Awards:

1st Place—Hathaway Club, Boone County  
2nd Place—McKinney Club, Lincoln County  
3rd Place—Briarwood Club, Warren County

Special Individual Awards: April Miller and Loretta Lyons

Exemplary Award for Area International Chairmen

Marcia Rasner, Mammoth Cave Area

Michelle Lawson, Lincoln Trail Area

Jan Hayes, Purchase Area

Lelia Gaines, Green River Area

**Leadership Development**—Martha Sue Hargrove, State Chairman

Evans/Hansen/Weldon Scholarship

Taylor Back

Kayelee Autumn Hudson

Taylor Stewart

Community Volunteerism Awards Club Awards

1st Place—Fernleaf Homemakers, Mason County  
2nd Place—Meade County Homemakers Association  
3rd Place—Gallatin County Homemakers Association

Scholarship Challenge

1st Place—Marshall County      2nd Place—Bracken County  
3rd Place—Bath County

Invitation to 2018 State Meeting—May 7-9, 2018

Tammy Penix, Northeast Area President

Crowne Plaza Hotel, Louisville, Kentucky (See page 16 for additional details.)

Installation of Officers & Chairmen

Susan Hansford, KEHA Past President

Closing Remarks—Marlene McComas, KEHA 1st Vice President

Reciting of the Creed—(see page 15)

## KEHA MEMBERSHIP TENURE RECOGNITIONS

### 50 Years

#### **Bourbon**

Janice Sosby

#### **Bullitt**

Nancy Armstrong  
Reba Mills

#### **Daviess**

Susan Bartlett  
Jan Houtchen

#### **Fayette**

Doris Strong

#### **Floyd**

Dorothy Harris

#### **Harrison**

Evelyn McCauley

#### **Hart**

Alma Ford

#### **Jessamine**

Margaret Woodward

#### **Leslie**

Faye Couch

#### **Lincoln**

Donna Austin

#### **Madison**

Fern Botkin  
Helen Eden

### 50 Years (continued)

#### **Mason**

Nadine Barker  
Mary Alice Botkins

#### **Nelson**

Merrylen Sparks

#### **Nicholas**

Lois Hamm  
Lillian Letcher  
Patsy Smoot  
Louise Zachary

#### **Ohio**

Barbara Atherton  
Frances Southard

#### **Pulaski**

Sheilah Childers

#### **Rowan**

Mabel Forman

#### **Scott**

Artie Burgess  
Thelma Duff  
Christine Kestel  
Mary Sue Kries  
Dorothy Stuard  
Lula Taylor  
Janet Wagoner

### 50 Years (continued)

#### **Taylor**

Helen Barnett

#### **Union**

Linda Stevens

#### **Woodford**

Gloria Redden

### 60 Years

#### **Ballard**

Merlene Cooper

#### **McCracken**

Robbie Wallace

#### **Monroe**

Susie Harlan

#### **Ohio**

Virginia Boyd

#### **Scott**

Dorothy Hassloch

#### **Union**

Irene Jennings

### 65 Years

#### **Allen**

Sue Nell Harwood

#### **Gallatin**

Betty Samuels  
Mayme Walters

#### **Harrison**

Vivian Smith

#### **Scott**

Mildred Gregory  
Thelma Perkins  
Joann Sharpe

#### **Warren**

Betty Magers

### 70 Years

#### **Boone**

Almeda Rea

#### **Lincoln**

Lucille Hammons

#### **Madison**

Nannie Reid

#### **Perry**

Lorinda Fugate

#### **Union**

Della Robinson

## *Congratulations to the 2017*

### *"3 for 3" Counties*

(Increased membership by at least 3 members)

Adair	Barren	Bath	Bell
Bourbon	Boyd	Bracken	Breathitt
Breckinridge	Caldwell	Campbell	Carlisle
Carter	Clark	Clay	Edmonson
Fayette	Fulton	Gallatin	Garrard
Jackson	Kenton	Knott	Laurel
Letcher	Logan	Madison	Magoffin
Martin	Mason	Meade	Morgan
Oldham	Owsley	Perry	Pulaski
Shelby	Spencer	Todd	Union
Webster	Whitley		

## Kentucky Extension Homemaker Association 2016-2017 State Board

### Officers

President .....	Mary Margaret Krahulec, Shelby County
1st Vice President for Program .....	Marlene McComas, Grant County
2nd Vice President for Member Resources .....	Marena Nelson, Floyd County
Secretary .....	Starlene Harris, Carter County
Treasurer .....	Sandra Lennon, Logan County

### Educational Chairmen

Cultural Arts & Heritage .....	Julia Lainhart, Jessamine County
Environment, Housing and Energy .....	Debbie Pierce, Woodford County
Family & Individual Development .....	Marilyn Craycroft, Meade County
Food, Nutrition & Health .....	Michelle Lawson, Meade County
4-H Youth Development .....	Nancy Snouse, Greenup County
International .....	Leonidisa Mundelius, Lincoln County
Leadership Development .....	Martha Sue Hargrove, Muhlenberg County
Management & Safety .....	Victoria Orme, Montgomery County

### Area Homemaker Presidents

PURCHASE .....	Julie Hook, Carlisle County
PENNYRILE .....	Dixie Utter, Lyon County
GREEN RIVER .....	Edna McCrady, Daviess County
MAMMOTH CAVE .....	Loretta Lyons, Monroe County
LAKE CUMBERLAND .....	Judy Rexroat, Russell County
LINCOLN TRAIL .....	Janet Hobbs, Meade County
LOUISVILLE .....	Joyce Crigler, Bullitt County
NORTHERN KENTUCKY .....	Barbara Seiter, Boone County
FORT HARROD .....	Brenda Hammons, Lincoln County
BLUEGRASS .....	Pat Skinnemoen, Clark County
LICKING RIVER .....	Ann Porter, Mason County
NORTHEAST .....	Tammy Penix, Johnson County
QUICKSAND .....	Henrietta Sheffel, Breathitt County
WILDERNESS TRAIL .....	Pat Klink, Laurel County

### Other (non-voting Board Members)

Parliamentarian .....	Alice Brown, Greenup County
Master Farm Homemaker .....	Martha Boyd, Mason County
KEAFCS .....	Liz Kingsland, Fayette County
KEHA Advisor .....	Kim Henken
Director, School of Human Environmental Sciences/ .....	Dr. Ann Vail
Assistant Director, Family & Consumer Sciences Extension	

## Family & Consumer Sciences Agents by County

Adair – Kelli Bonifer  
Allen – Janet Johnson  
Anderson – vacant  
Ballard – vacant  
Barren – Betsy Ann Tracy  
Bath – Nicole Gwishiri  
Bell – Rebecca Miller  
Boone – Diane Mason  
Boone – Katie Trump  
Bourbon – Karen Denniston  
Boyd – Eugenia Wilson  
Boyle – Alethea Price  
Bracken – Shannon Smith  
Breathitt – Kayla Watts  
Breckinridge – Lynette Allen  
Bullitt – Ruth Chowning  
Butler – Tracy Thornton Cowles  
Caldwell – Ashley White  
Calloway – vacant  
Campbell – Ronda Rex  
Campbell – Kate Thompson  
Carlisle – vacant  
Carroll – Cathy Jansen  
Carter – Whitney Morrow  
Casey – Deborah Shepherd  
Christian – Tiffany Bolinger  
Clark – Jennifer Howard  
Clay – Lora Lee Frazier Howard  
Clinton – Christy Nuetzman  
Crittenden – vacant  
Cumberland – Debbie Messenger  
Daviss – Mary Higginbotham  
Edmonson – Julia Wilson  
Elliott – Gwenda Johnson  
Estill – Thays Flores  
Fayette – Diana Doggett  
Fayette – Liz Kingsland  
Fleming – Donna Fryman  
Floyd – Andi Johnson  
Franklin – Tamera Thomas  
Fulton – Anna McCoy  
Gallatin – Sherri Broderick  
Garrard – Mary Hixson  
Grant – Rachael Price  
Graves – vacant  
Grayson – Natalie Taul  
Green – Jordan Crain  
Greenup – Lora Pullin  
Hancock – vacant  
Hardin – Dayna Parrett  
Harlan – Lora Davidson  
Harrison – Benita Peoples  
Hart – Janey Cline  
Henderson – Amanda Hardy  
Henry – Maryellen Garrison  
Hickman – Melissa Goodman  
Hopkins – Katherine Jury  
Jackson – Clare Kincaid  
Jefferson – Monique Pearce (KSU)  
Jefferson – Valerie Holland  
Jessamine – Karli Jessie  
Johnson – Brenda Cockerham  
Kenton – Kathy Brynes  
Kenton – Linda Brown-Price (KSU)  
Kenton – Joan Bowling  
Knott – Linda Combs  
Knox – Danielle Barrett  
LaRue – Theresa A. Howard  
Laurel – Judi O'Bryan  
Lawrence – Alivia Faris (6/1/2017)  
Lee – Laken Campbell (6/1/2017)  
Leslie – Brittany Evans  
Letcher – Nanette Banks  
Lewis – Mandi Broderick  
Lincoln – Rita Stewart  
Livingston – Morgan Rousseau  
Logan – Rachel Hance  
Lyon – Angie York  
Madison – Gina Noe  
Magoffin – vacant  
Marion – Danielle Ford  
Marshall – Vicki Wynn  
Martin – Sarah Sumpter  
Mason – Heather Cheek  
McCracken – Denise Wooley  
McCreary – Amy Fugate  
McLean – Amanda Dame  
Meade – Jennifer Bridge  
Menifee – Kendyl Whaley  
Mercer – Luci Hockersmith  
Metcalfe – Lynn Blankenship  
Monroe – vacant  
Montgomery – Hannah Mayrand  
Morgan – Nellie Buchanan  
Muhlenberg – Mary Beth Riley  
Nelson – vacant  
Nicholas – Madison Showalter (6/1/2017)  
Ohio – Tiffany Calvert

## Family & Consumer Sciences Agents by County

Oldham - Chris Duncan  
 Owen – Judy Hetterman  
 Owsley – vacant  
 Pendleton – Kenna Knight  
 Perry – Glenna Sue Wooten  
 Pike – Leslie Workman  
 Powell – vacant  
 Pulaski – Edith Lovett  
 Robertson – Sue Hughes  
 Rockcastle – Hazel Jackson  
 Rowan – Peggy Jones  
 Russell – Pam York  
 Scott – Whitney Hilterbran  
 Shelby – Sheila Fawbush

Simpson – Christy Ramey  
 Spencer – Allison Lewis  
 Taylor – Audrey Myers  
 Todd – Jill Harris  
 Trigg – Cecelia Hostilo  
 Trimble – Jane Proctor  
 Union – Melanie Bealmeear  
 Warren – vacant  
 Washington – Cabrina Buckman  
 Wayne – Jody Paver  
 Webster – Katie Alexander  
 Whitley – Matti Daniels  
 Wolfe – vacant  
 Woodford – Elizabeth Coots

### District Directors

District 1 (Licking River/Northeast) - Natasha Lucas  
 District 2 (Quicksand/Wilderness Trail) - Daniel Wilson  
 District 3 (Louisville/Northern Kentucky) - Willie Howard  
 District 4 (Fort Harrod/Bluegrass) - Jenny Cocanougher  
 District 5 (Lake Cumberland/Lincoln Trail ) - Anna Smith  
 District 6 (Green River/Mammoth Cave) - David Herbst  
 District 7 (Purchase/Pennyrile) - Matt Fulkerson

### University of Kentucky Advisors to State Educational Chairmen

Cultural Arts & Heritage . . . . .	Connee Wheeler, Senior Extension Associate
Environment, Housing and Energy . . . . .	Mindy McCulley, Extension Specialist for Instructional Support
Family & Individual Development . . . . .	Amy Hosier, Associate Extension Professor/Family Life Specialist
Food, Nutrition & Health . . . . .	Heather Norman-Burgdolf, Assistant Extension Professor/Food & Nutrition Specialist
4-H Youth Development . . . . .	Kimberly Adams, Extension Specialist for 4-H Youth Development
International . . . . .	Kim Miller Spillman, Associate Professor, Department of Retailing and Tourism Management
Leadership Development . . . . .	Kim Henken (interim), Director of Communications/KEHA State Advisor
Management & Safety . . . . .	Jennifer Hunter, Associate Extension Professor/Family Financial Management Specialist

# *KEHA Presidents*

1932-33	* Mrs. Lyda Lynch Hall, Fayette County
1934-35	* Mrs. W.M. Oliver, McCracken County
1936-38	* Mrs. T.M. Johnston, Warren County
1939-41	* Mrs. H.L. Crafton, Henderson County
1941-43	* Mrs. P.W. Adkins, Bell County
1943-45	* Mrs. Ralph Scearce, Shelby County
1945-46	* Mrs. W.E. Nichols, Fayette County
1946-49	* Mrs. W.K. Morris, Christian County
1950-53	* Mrs. Wade Hold, Nelson County
1953-56	* Mrs. R. Matchett, Kenton County
1956-59	* Mrs. Virgil Grayson, Pulaski County
1959-62	* Mrs. Carl Evans, Ballard County
1962-65	* Mrs. Harry J. Braun, Campbell County
1965-68	* Mrs. James T. Brookshire, Breckenridge County
1968-71	* Mrs. Earl Friedly, Scott County
1971-74	* Mrs. Howard Taylor, Harrison County
1974-77	* Mrs. Mitchell Bertram, Barren County
1977-80	* Mrs. Samuel Whitt, Jr., Boyd County
1980-83	* Mrs. James Wallace, Caldwell County
1983-86	* Mrs. M.D. Perkins, Campbell County
1986-89	Mrs. L.E. Moorhead, Bracken County
1989-92	* Helen Palmer, Clark County
1992-95	Jean Davis, Hardin County
1995-98	Velma Koostra, Warren County
1998-2001	* Kathleen Hockersmith, Oldham County
2001-04	Mabel Harned, Nelson County
2004-07	* René Siria, Franklin County
2007-10	Linda Kaletch, McCracken County
2010-13	Alice Brown, Greenup County
2013-16	Susan Hansford, Pulaski County
2016-	Mary Margaret Krahulec, Shelby County

\* Deceased

## ***Kentucky Homemaker Creed***

I believe in the home as an inspiring and happy center of family life - comfortable and attractive - a place for relaxation and work where pleasures and responsibilities are shared.

I believe in the home and its contribution to community life which reflects the development of the homemaker and the family.

I believe in the homemaker - alert, diligent, in search of better ways of doing ordinary things for the welfare and happiness of the family.

I believe in the homemaker as a community leader responsible for passing on to others mastered skills and knowledge.

I believe in the fellowship that comes through the homemakers organization - the exchange of ideas and the joy of knowledge shared with others, thus broadening our lives and lifting household tasks above the commonplace.

For these opportunities I am grateful.  
I am also thankful for the courage of yesterday,  
the hope of tomorrow,  
and a growing consciousness of God's love always.

---



# Thank You

*A special thank you goes to all those who helped make the  
2017 State Meeting in Owensboro a success.*

To the Green River Area Host Committee for their  
outstanding contributions and warm hospitality.

To each of the 14 areas for fulfilling their responsibilities before  
and during the state meeting.

To the KEHA Executive Committee and Educational Chairmen.

To the Extension agents, specialists, and all presenters of learning sessions.

To the vendors who participated in our trade show.

To the staff of the Owensboro Convention Center and  
conference hotels for your hospitality and service.

To all of our speakers and session presenters,  
thank for you sharing your time.

---

**Make plans to attend the  
2018 KEHA State Meeting  
at the  
Crowne Plaza Louisville Airport!**

***May 7-9, 2018***

**Make your reservations beginning July 1, 2017 for the  
2018 KEHA State Meeting at the Crowne Plaza Louisville Airport!**

Crowne Plaza Louisville Airport  
830 Phillips Lane, Louisville, Kentucky 40209  
Phone: (888) 233-9527

Rate: \$104 (king/double) or \$129 (suite) + tax (1-4 people)

Please make reservations prior to April 6, 2018 to guarantee receiving this rate.  
Request the Ky Extension Homemakers Association or KEHA rate when calling.

---





## 2017 KEHA Choir

*Directed by: Wendy Hood,  
Mercer County*



Jean Aull, Breckinridge County  
Connie Bates, Wayne County  
Machele Bess, Owen County  
Rose Booth, Grayson County  
Melanie Cantrell, Johnson County  
Kathy Diaz, Lincoln County  
Helen Eden, Madison County  
Loretta Fitzgerald, Caldwell County  
Carolyn French, Breckinridge County  
Holly Gregory, Breckinridge County  
Brenda Hammons, Lincoln County  
Susan Hansford, Pulaski County  
Starlene Harris, Carter County  
Deborah Heisel, Fulton County  
Luci Hockersmith, Mercer County  
Wendy Hood, Mercer County  
Linda Kaletch, McCracken County  
Kathy King, Boyd County  
Loraine King, Jessamine County  
Mary Marlowe, Owen County

Flo McDonald, Pendleton County  
Carol McKinnon, Oldham County  
Louise Moneyhon, Bracken County  
Marena Nelson, Floyd County  
Victoria Orme, Montgomery County  
Debbie Pierce, Woodford County  
Marilyn Powell, Mercer County  
Elizabeth Prewitt, Owen County  
Jane Qualls, Carter County  
Vicki Ramsier, Breckinridge County  
Phyllos Ross, Harrison County  
Ruth Sharrard, Fayette County  
Pat Sullivan, Ballard County  
Lynda Turner, Breckinridge County  
Marilyn Watson, Henderson County  
Sharon Wood, Taylor County  
Bobbie Wray, Ballard County  
Karen Yerkey, Breckinridge County



1st Floor / Lower Level

Exhibit Hall 1

Exhibit Hall 2

Exhibit Hall 3

East Lower Lobby

Café

Registration 2 and 3

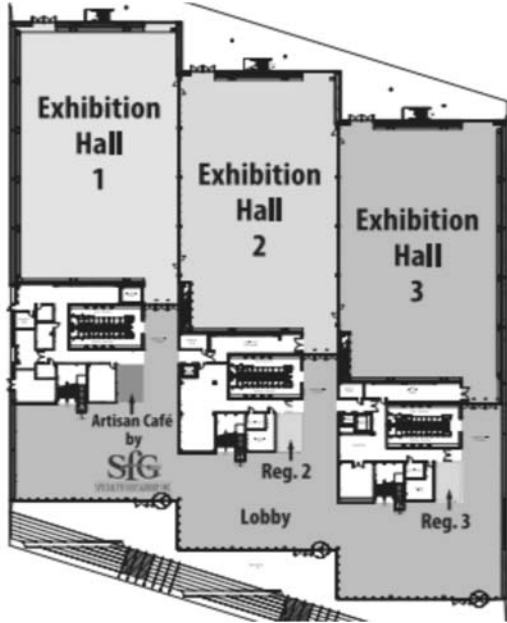

2nd Level / Mezzanine Level

Meeting Room 210

*Access via West Escalator*

Meeting Room 220

*Access via West Elevator*

Meeting Room 230

*Access via East Elevator*

Meeting Room 231

*Access via East Elevator*

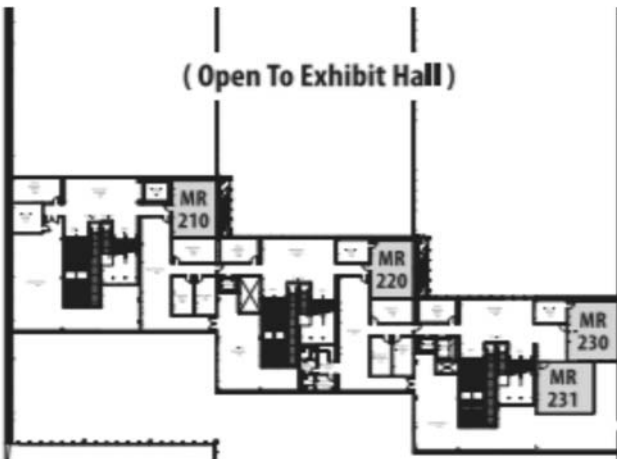

3rd Level / Upper Level

East Ballrooms A, B, C, D, E

West Ballroom A, B, C, D, E

Riverview Room

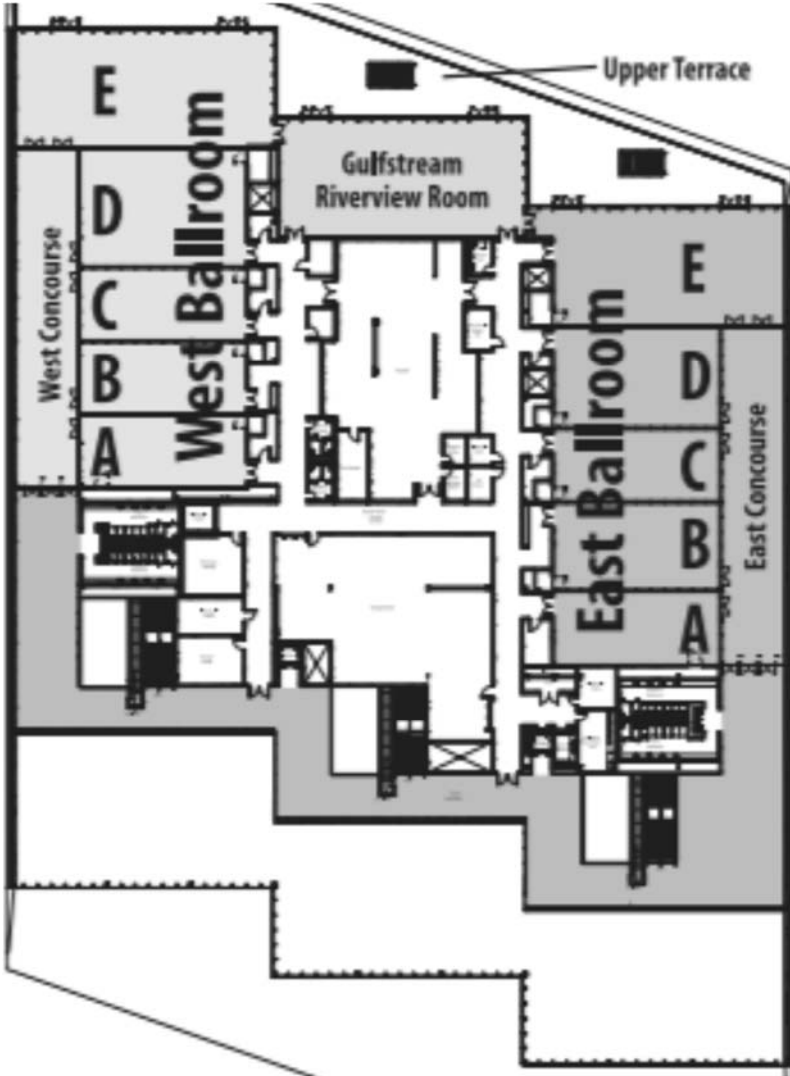

Please circle appropriate number scoring #10 as the highest rating; #1 as the lowest.

Overall Meeting

1 2 3 4 5 6 7 8 9 10

What did you enjoy most this year?

Which seminar or session did you find most beneficial?

Is there someone you would recommend as a keynote speaker for next year?

Is there a seminar topic or presenter you would suggest for next year?

Would you recommend this location for a future state meeting?

Other HELPFUL suggestions: